

SANSUI

AU-11000A INTEGRATED STEREO AMPLIFIER
AMPLIFICATEUR STÉRÉO INTÉGRÉ
INTEGRIERTER STEREOVERSTÄRKER



OPERATING INSTRUCTIONS
MODE D'EMPLOI
BETRIEBSANLEITUNG

Sansui

WARNING: To prevent fire or shock hazard, do not expose this appliance to rain or moisture.

ATTENTION: Pour éviter les dangers d'électrocution ou d'incendie, ne pas exposer cet appareil à la pluie ou à l'humidité.

WARNUNG: Setzen Sie dieses Gerät zur Verhütung von Feuer und Stromschlaggefahr weder Regen noch Feuchtigkeit aus.

We are grateful for your choice of the AU-11000A stereo integrated amplifier. Before you begin operating your AU-11000A, we suggest that you read this booklet of operating instructions once carefully. You will then be able to connect and operate it correctly, and enjoy its superb performance for years to come.

Table of contents

| | |
|----------------------------|----|
| FUNCTIONAL FEATURES | 2 |
| IMPORTANT PRECAUTIONS | 4 |
| CONNECTION | 6 |
| PANEL INFORMATION | 14 |
| SOURCE PLAYBACK PROCEDURES | 22 |
| SOME USEFUL HINTS | 30 |
| SPECIFICATIONS | 34 |

FUNCTIONAL FEATURES

- * Versatile phono circuits
Two PHONO inputs are provided on the unit, so that you can connect two turntables or two tonearms. To make the most of each of your cartridges/turntables, three types of input sensitivities and pickup loads are available with the PHONO-1.
- * Circuits for two tape decks
Two decks can be connected. It's possible to record into both at the same time or to dub one onto the other.
- * Terminals for two pairs of speakers
Driving either or both of two pairs of speakers or none can be selected by a switch.
- * Versatile tone-adjusting and filtering controls
Sansui exclusive TTC (Triple Tone Controls) are provided with a midrange control added. There are also three selectable turnover frequencies for BASS and TREBLE each. The TONE & FILTER switch has a DEFEAT position for an instant flat response.
- * Pre/main amplifier-separating switch provided
The unit's power amplifier and preamplifier sections can be separated for independent use by the PRE-MAIN separate switch. Use the "SEPARATED" position when connecting a separate control amplifier or power amplifier or when building an electronic crossover system.
- * Fail-safe protection circuits
Protection circuits are activated in cases of unusually high internal temperature, overloads or DC unbalance at the output. The output signals are not released to the speakers until the trouble is remedied.

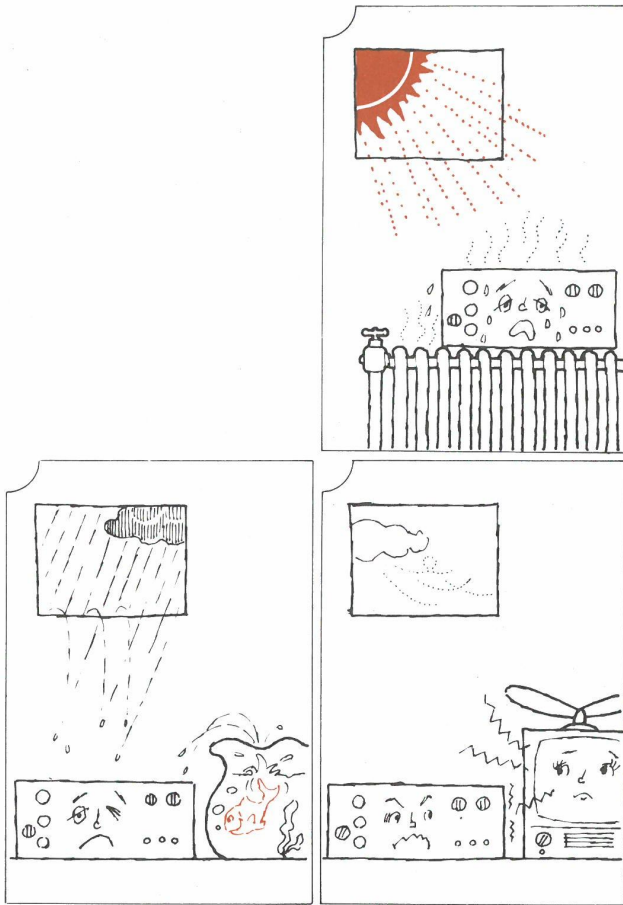

IMPORTANT PRECAUTIONS

To keep the unit in top condition at all times, observe the following precautions.

Installation locations

- * Do not expose the unit to rain or sun. Such exposure is dangerous, since it may eventually be the cause of circuit burnout or fire, or give electric shock to whomever touches the unit.
- * Avoid extremely dusty locations, or close proximity to heating appliances or placing it in direct sunlight.
- * Never remove the side and bottom plates. Such removal is both physically and electrically dangerous to you and the unit.
- * Keep the unit away from TV sets to avoid buzz noise.

Installation

You should mount the unit on a solid shelf or stand. Of the five feet on the unit's bottom board, the two, located near the rear panel, can be moved 4.5 cm (2 inches) toward the front panel, a feature useful when mounting the unit on a narrow shelf. The screws, located in the oval recesses in the bottom board, are provided for this purpose. Never remove the feet for mounting, since the ventilation outlets will be blocked, giving rise to the possible cause of breakdown.

Ventilation

Never obstruct the ventilation outlets on the unit's top, bottom boards, and on the rear panel. Take extra care about ventilation when placing equipment, etc. atop the unit or mounting the unit in a sealed box; using the unit in such a condition may lead to an eventual breakdown. There's a protection circuit inside the unit that cuts the output temporarily in case the internal temperature rises above a certain level.

CONSTRUCTION OF AN AUDIO SYSTEM
MONTAGE D'UNE CHAÎNE AUDIO
AUFBAU EINES AUDIOSYSTEMS

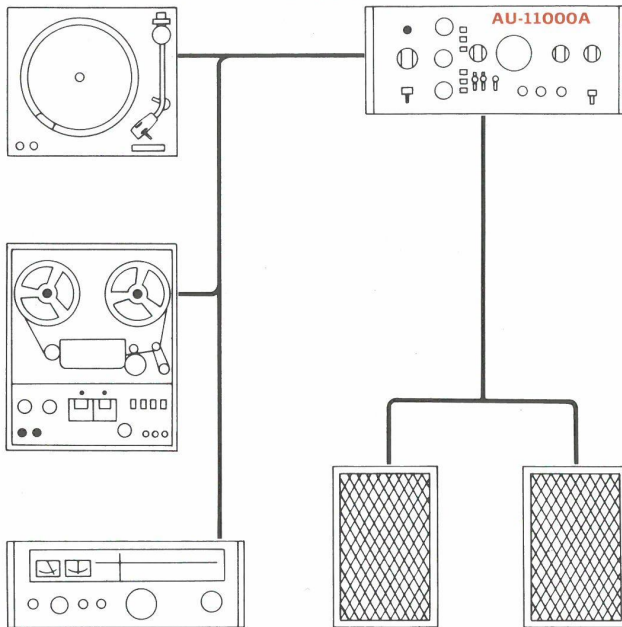

CONNECTION

Note

- * Prior to any connection, be sure that the POWER switch is at the OFF position.
- * When using the "SWITCHED" and "UNSWITCHED" AC outlets of the unit, never connect components whose total power consumption exceeds the capacity of each outlet.
- * In connecting tape decks, do not use the TAPE-2 pin-jack terminals and the DIN socket simultaneously.
- * Noise and breakdown may be caused when defective cords are used, when connection is imperfectly made or when loose ends of connection cord lead wires are in contact with the unit or other components. Therefore, when connections are completed, check that they are correctly made and that the plugs and connection cords are in proper working condition.

Speaker impedance

When connecting one pair of speaker systems, each of them may have any impedance from 4 to 16 ohms. When connecting two pairs, each must be from 8 to 16 ohms. Breakdown may occur if you use speaker systems with lower-than-specified impedances. Follow this instruction strictly when driving two pairs of systems simultaneously. Impedance of a speaker system is usually specified on the unit itself or in its instruction leaflet.

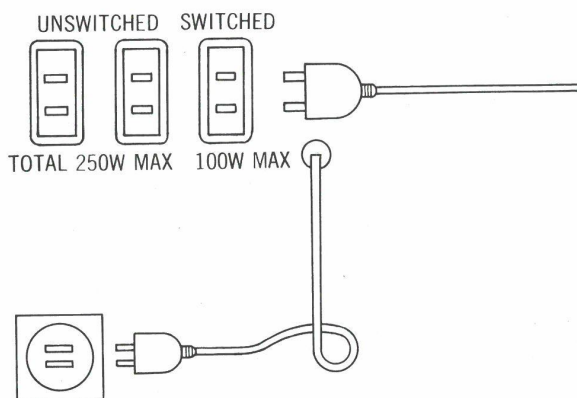

NOTE: No AC outlet is provided on units sold in some areas owing to local laws and regulations.

REMARQUE: Aucune sortie AC (Courant Alternatif) n'équipe les modèles vendus dans certaines régions en raison des règlements locaux.

ANMERKUNG: Aufgrund örtlicher Vorschriften und Gesetze sind in manche Gebiete gelieferte Geräte nicht mit Wechselstrombuchsen ausgestattet.

AC outlets

Of the three AC outlets provided on the rear panel, the one, marked "SWITCHED," is controlled by the front-panel POWER switch. It is convenient to use it to power a program source component such as your turntable, etc.

The other two AC outlets, marked "UNSWITCHED," are not controlled by the unit's POWER switch; so long as the unit is connected to a wall outlet, the connected components are also powered.

The "SWITCHED" and "UNSWITCHED" outlets have a capacity of 100 watts and 250 watts respectively. Do not connect any component whose power consumption exceeds the capacity of each outlet, as it is extremely dangerous. The power consumption rating is usually listed in the specification chart of the component, or sometimes on the equipment itself; be sure to check the rating.

- In case you have connected a component to one of the unit's AC outlets and then another component to the first component's AC outlet, be sure to add the second component's rated power consumption to the consumption of the components connected to the unit itself.

Short pin-plugs

Pin-Plugs are inserted in the PHONO-2 terminals of the unit to decrease noise prior to delivery from our factory. Since unused terminals without short pin-plugs can cause an increase in noise, be sure to keep them inserted when you use only one turntable. Never re-insert them into the TAPE REC, PRE OUT, or MAIN IN terminals, for then you will be unable to hear any sound at all.

Cable guides on side panels

Terminals for the inputs and outputs are provided on the side panels of the unit: inputs on the right panel and outputs on the left. Since they are located near the front panel, you can make connections easily after simply pulling the unit out toward you. Connection cables can be bundled neatly when they are run behind the cable guides.

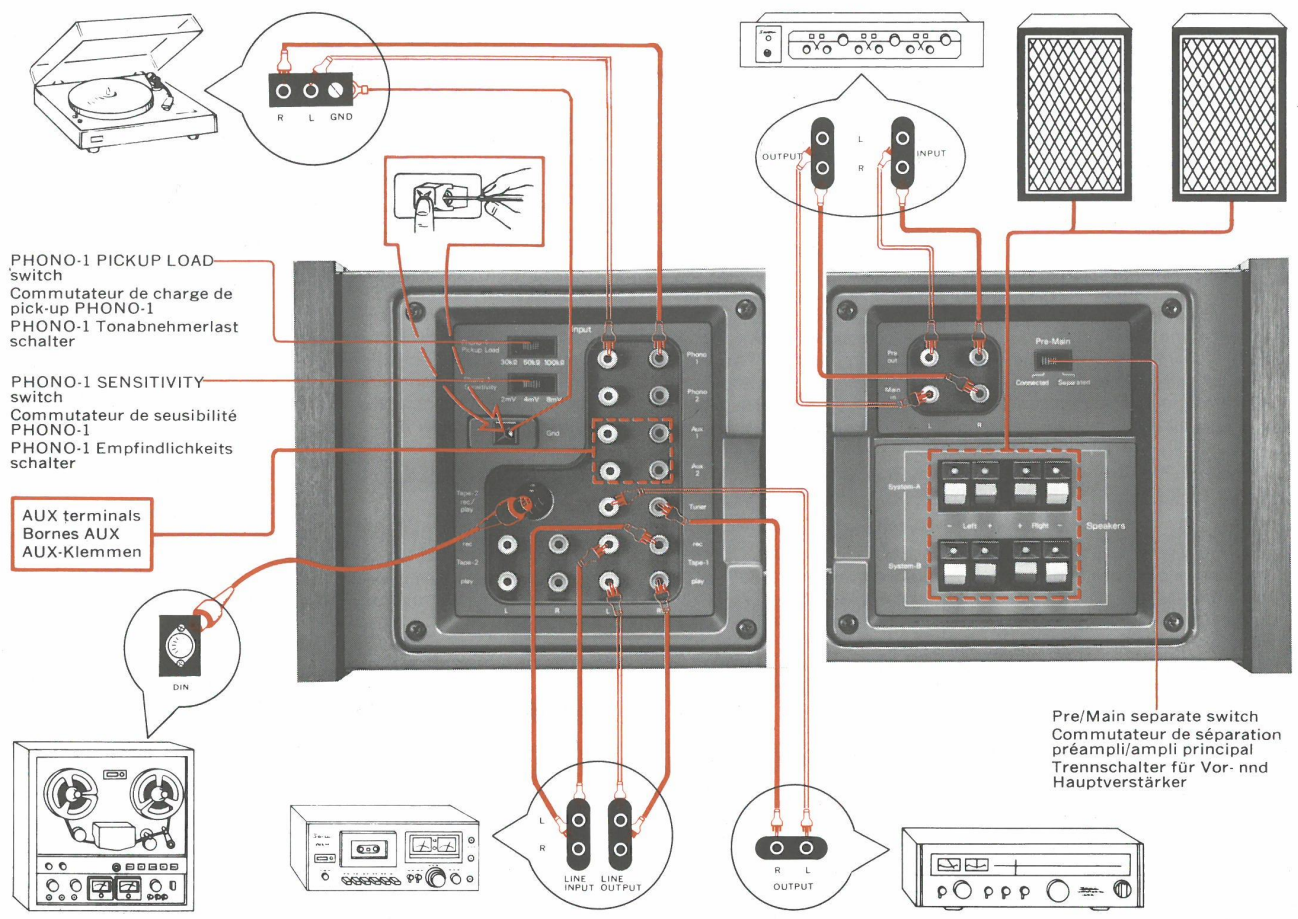

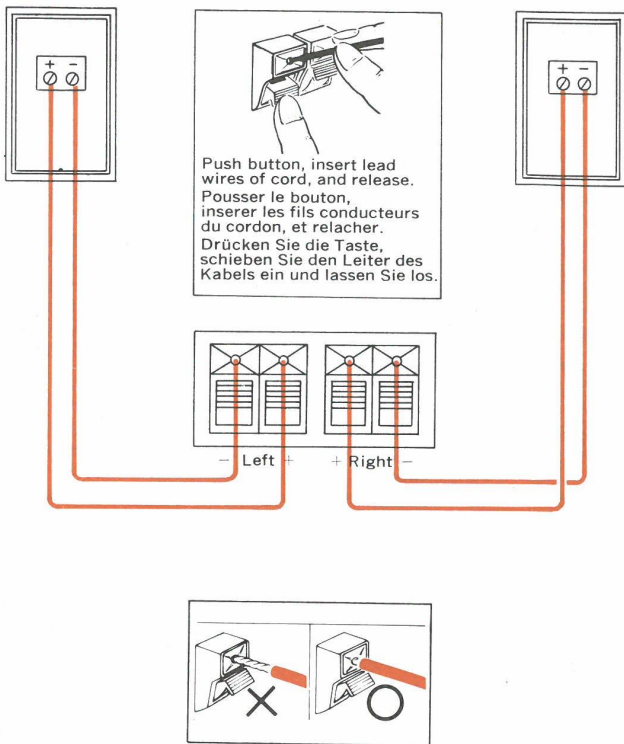

Speaker connection

To SPEAKERS SYSTEM-A or B terminals, connect speaker cords taking care not to confuse the right channel with the left and plus polarity with minus.

Connecting a tuner

A tuner should be connected to the TUNER terminals on the right side panel. If there's an output level control on your tuner, adjust it so that the tuner output level matches the phono output level; you will then be saved the trouble of adjusting the volume each time you change the program sources.

Since an antenna is indispensable for good radio reception, especially of FM broadcasts, you are advised to install a quality antenna and, moreover, use quality cords for connection.

Turntable connection

Connect your turntable to the PHONO-1 terminals. When using two turntables or two tonearms, use the PHONO-2 terminals too. When your turntable is equipped with a grounding cable, connect it to the unit's GND terminal. But disconnect it when you notice increased hum.

Tape deck connection

You can connect up to two tape decks to the unit. Connect the unit's TAPE REC terminals to the line input terminals of your tape deck, and the unit's TAPE PLAY terminals to the output terminals of the deck. The DIN socket connects with the identical socket on your tape deck via a DIN cable.

- The TAPE-2 circuit is duplicated, one by pin jacks and the other by the DIN socket. Do not use the jacks and the socket at the same time.
- For information about the AUX PHONO-1 PICKUP LOAD, PHONO-1 SENSITIVITY and PRE-MAIN Separate Switches, refer to the section SOME USEFUL HINTS.

• This page folds out for use as reference while reading the rest of the booklet.

• Cette page se plie à l'extérieur pour l'utiliser comme référence tout en lisant le reste de la notice.

• Bitte klappen Sie diese Seite heraus, wenn Sie den Rest dieser Anleitung durchlesen.

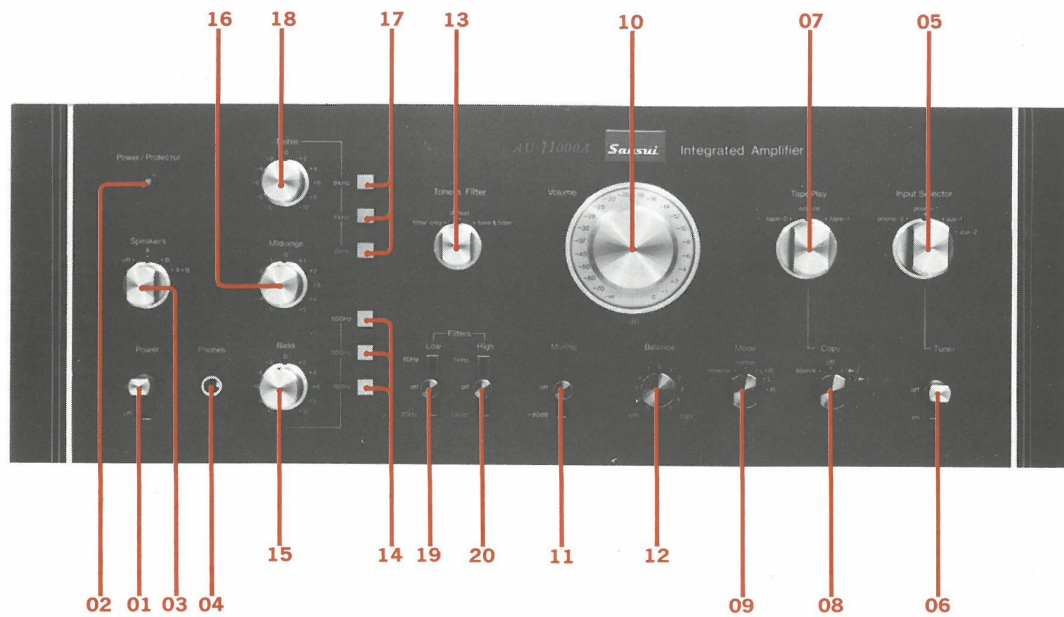

Power/Protector



Speakers

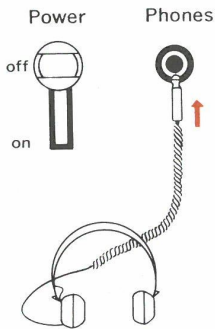
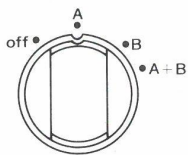

Input Selector

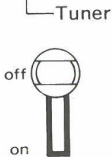
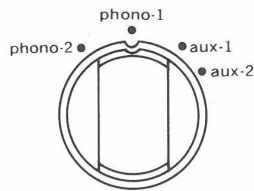

PANEL INFORMATION

01 POWER Switch

02 POWER/PROTECTOR Indicator

Raise the switch to ON to turn the unit on, flip it down to OFF to turn it off.

When the POWER switch is set to ON, the indicator glows red, and it turns green a few seconds later to indicate safe operation of the unit. Where there is some malfunction somewhere in the unit's circuitry during operation, the indicator turns red. Should the indicator turn red during operation, turn the power off and check for possible cause.

03 SPEAKERS Switch

04 PHONES Jack

The SPEAKERS switch selects the speaker system(s) you want to hear. When listening through a headset, insert its plug into the PHONES Jack.

OFF: To cut off the source from the speaker systems when listening with headphones.

A or B: To drive the speaker systems connected to the SPEAKER SYSTEM-A or B terminals.

A+B: To drive both sets of speaker systems simultaneously.

05 INPUT SELECTOR Switch

Use this switch to hear a component connected to the PHONO or AUX terminals.

PHONO-1, 2: To play records. With the PHONO-1 circuit, you can change the input sensitivity and pickup load. For details, refer to pp. 30, 31.

AUX-1, 2: To hear a component connected to the AUX terminals.

06 TUNER Selector

Flip this switch down to ON to hear radio broadcasts through the tuner connected to the TUNER terminals.

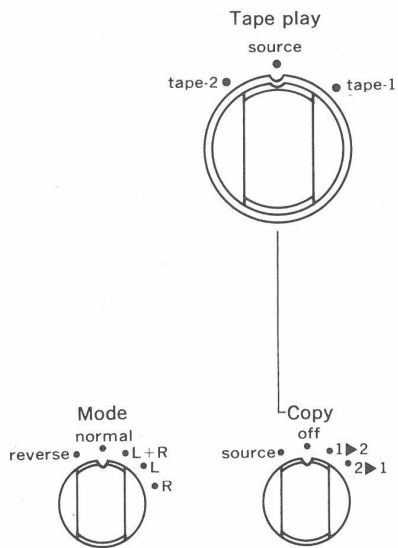

07 TAPE PLAY Switch

Turn this switch to TAPE-1 or TAPE-2 only when you operate the tape deck(s) (for playback or recording) connected to the TAPE terminals. At all other times, it should be at the SOURCE position.

TAPE-1, 2: To hear playback of a tape or monitor sounds as they are recorded.

SOURCE: To hear sources other than tapes.

08 COPY Switch

Use this switch when recording. When not recording, keep it at the OFF position.

SOURCE: To record disc records and radio broadcasts.

OFF: To hear a program source without it.

With the switch set at OFF, the unit's TAPE REC terminals are separated from the connected tape decks. Thus you can avoid harmful electrical interference of the tape decks while you listen to records and radio broadcasts without recording.

1>2, 2>1: To undertake tape dubbing.

09 MODE Switch

Select the reproduction mode with this switch.

NORMAL: To hear sound reproduction in normal stereo.

REVERSE: To hear sound reproduction in reverse stereo (left channel from right speakers and vice versa).

L+R: To hear sound reproduction in mono (the mixed left and right sound from all the connected speakers).

L: To hear a left-channel sound from all connected speakers.

R: To hear a right-channel sound from all connected speakers.

- To hear left-channel sound from left speakers, or right-channel sound from right speakers, use the BALANCE control.

- Please shift MODE switch to position of stereo (either NORMAL or REVERSE), when recording is required.

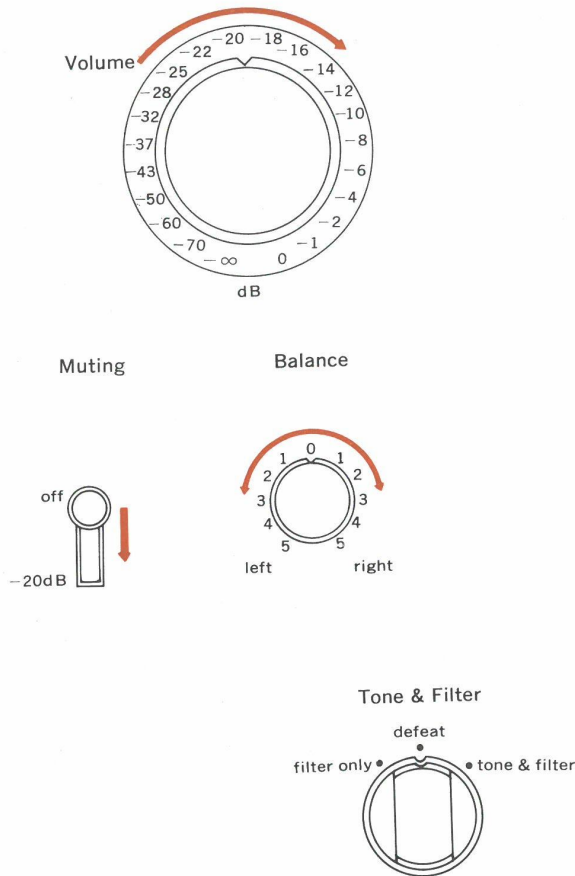

10 VOLUME Control

The overall volume is controlled by the VOLUME control. Adjust it while actually listening to music. The more it is turned to right, the louder the volume becomes.

11 MUTING Switch

With this switch, you can reduce the volume by 20 dB instantly. It is most convenient when you reduce the volume temporarily on such occasions as when you answer a phone call or place a stylus on the record surface.

12 BALANCE Control

The volume of the left and right channels can be adjusted by the BALANCE control; turn it clockwise to increase the right-channel volume or turn it counterclockwise to increase the left-channel volume. The farther away it is turned from its center position, the louder the corresponding channel. Stereo balancing is made easily: first set the MODE switch to the L+R position, adjust the BALANCE control so that the sound can be heard from the exact center between the two speakers, and set the MODE switch to NORMAL. If then you notice much difference in volume between the left and right channels, chances are the playback component may have unbalanced left and right output levels. Though you can rectify this with the BALANCE control on the unit, it is recommended that you check the connected components. Unbalanced tracking force is one of the often experienced causes of channel imbalance.

13 TONE & FILTER Switch

To adjust tone with the tone selectors and tone controls, first set the TONE & FILTER switch to the TONE & FILTER position. To obtain a flat response, set it to the DEFEAT position. Then the tone control circuits are switched out of circuit irrespective of the positions of the tone selectors and tone controls.

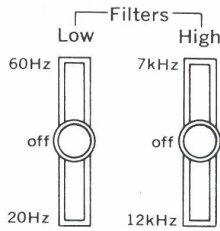
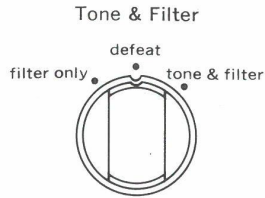
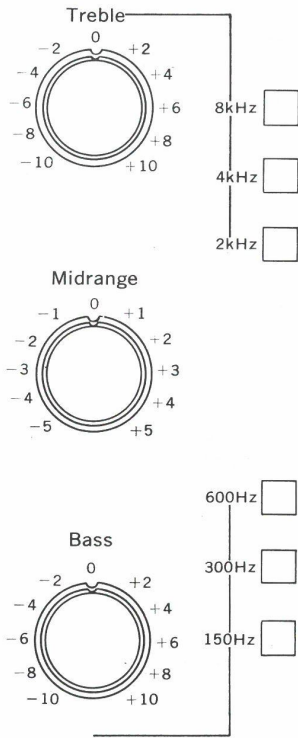

14 BASS Tone Selectors

15 BASS Tone Control

Use the BASS tone selectors and control to adjust the bass or low-frequency response of such an instrument as a bass. The BASS tone selector select the frequency below that to which the BASS tone control has been adjusted; use one of the three positions (600 Hz, 300 Hz or 150 Hz).

16 MIDRANGE Tone Control

Use this control to adjust the midrange or middle-frequency response of the human voice, etc. Its adjustment affects the frequencies centered around 1,000 Hz.

17 TREBLE Tone Selectors

18 TREBLE Tone Control

Use the TREBLE tone selectors and control to adjust the treble or high-frequency response of instruments such as cymbals. The TREBLE tone selectors select the frequency above that to which the TREBLE tone control has been adjusted; use one of the three positions (2 kHz, 4 kHz or 8 kHz).

13 TONE & FILTER Switch

To eliminate noise, set the switch to the FILTER ONLY position. To eliminate noise and adjust tone, set it to the TONE & FILTER position.

- If noise in the low or high frequency range is not irritating, set the LOW FILTER and HIGH FILTER switches to the OFF positions.

19 LOW FILTER Switch

This switch eliminates superlow-frequency noise such as hum, turntable rumble and other noise that warped and off-centered records cause. Two cut-off frequencies, 20 Hz and 60 Hz, are available.

20 HIGH FILTER Switch

You can eliminate with this switch the noise in the high-frequency range or hiss that is audible when scratchy records, FM stereo broadcasts or tapes are played. Use either the 7 kHz or the 12 kHz position, depending on which is the more effective.

SOURCE PLAYBACK PROCEDURES

Listening to records

1. Confirm that the VOLUME control is not turned too far to the right; it should be at a position where you can obtain the normal listening level.
2. Turn the INPUT SELECTOR switch to the PHONO-1 or 2 position. Confirm that the TUNER selector is at OFF, the TAPE PLAY switch at SOURCE, and the TAPE COPY switch at OFF.
3. Operate your turntable to play a record.
4. Adjust the unit's other controls and switches to suit the type of music you are going to listen to.
 - With the unit's PHONO-1 circuit, you can change the input sensitivity and pickup load. Use the proper switches to obtain the response that best suits your taste or the cartridge in use. See pp. 30, 31 for more information.

Poor-quality record reproduction

- * When you hear hum continuously, check the grounding of your turntable.
- * You may hear howling or acoustic feedback, caused when the pickup of your turntable is affected by the vibrating sound waves from the speakers, and undesired signals are amplified. To avoid howling, move the turntable away from the speakers or install the turntable on a solid, non-resonating stand. It can also be reduced when the turntable is placed at one of the corners of your room.
- * When you hear unstable, "shallow" reproduction during record playback, it is suggested that you check if there is dust accumulated on the surface of the record and on the stylus tip. The cause may be a worn stylus tip. When you use a record cleaner, be sure to always use one of high quality.

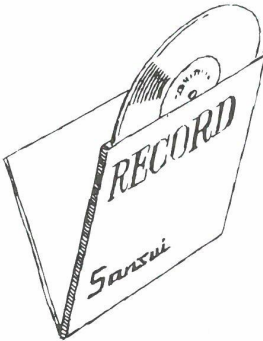

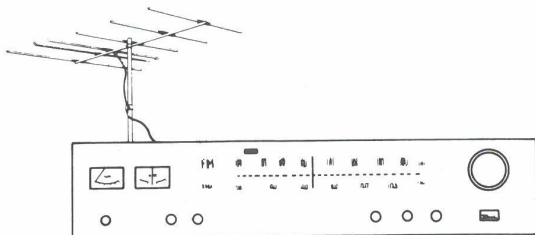

Listening to radio broadcasts

1. Confirm that the VOLUME control is not turned too far to the right; it should be at a position where you can obtain the normal listening level.
2. Set the TUNER selector to the ON position. Confirm that the TAPE PLAY switch is at the SOURCE position and the TAPE COPY switch at the OFF position.
3. Operate the tuner to receive the desired station.
4. Adjust the unit's other controls and switches to suit the type of music you are hearing.

Noise during radio reception

- * Weak FM signals are often disturbed by ignition noise from nearby automobiles and other noise. Therefore, for better FM reception, installation of an outdoor FM antenna is suggested. For antenna connection, be sure to use a coaxial cable, not a feeder-type cable.
- * When you hear noise during AM reception, there are innumerable conceivable causes, which makes it almost impossible to eliminate all AM noises. Use the unit's filters when both grounding the unit and mounting a noise-eliminating device fail to reduce such noise.

Playback of tapes

1. Confirm that the VOLUME control is not turned too far to the right; it should be at a position where you can obtain the normal listening level.
2. Turn the TAPE PLAY switch to the TAPE-1 or TAPE-2 position, depending on which TAPE PLAY terminals the corresponding deck is connected to.
3. Operate the tape deck to start playback.
4. Adjust the unit's other controls and switches to suit the type of music you are going to hear.

Poor-quality tape playback

High-frequency hiss is noise inherent in tape. Eliminate it with the unit's HIGH FILTER switch. The noise increases when the heads of your tape deck are magnetized. For elimination of such noise, refer to the instruction book of that tape deck.

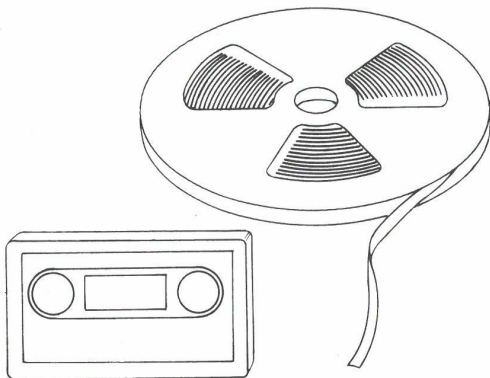

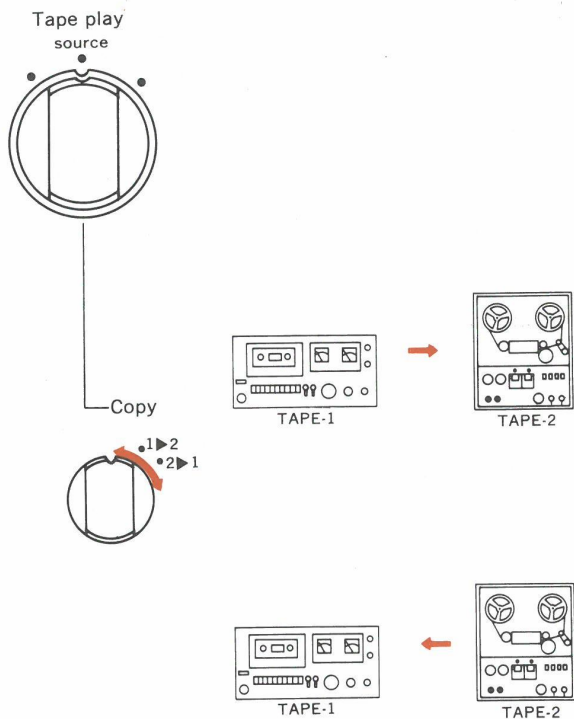

Recording disc records and radio broadcasts

You can record disc records or radio broadcasts on one or two connected tape decks at the same time. Recording level adjustments should be made with the tape decks.

1. Prepare a program source (records or radio broadcasts) you want to record.
 2. Set the TAPE COPY switch to the SOURCE position.
 3. Operate the tape deck(s) on which you are going to make a recording.
 4. If you want to monitor the sound as you record it, simply follow exactly the same instructions as for tape playback (described above). Also operate the tape deck(s) for monitoring. Monitoring is possible with a tape deck with independent heads for record and play. If your tape deck has a combined head for record and play, however, you cannot monitor; set the TAPE PLAY switch to the SOURCE position and listen to the sound before it is recorded.
- Recordings dubbed from disc records or radio broadcasts should not be used in public without prior consent of the original copyright owners.

Tape-to-tape copying

1. Adjust the TAPE COPY switch to one of its two positions: 1>2 or 2>1, depending on which tape deck you wish to use for playback and which tape deck for recording.
 2. Operate the tape decks, one for playback and the other for recording.
 3. If you wish to monitor the sound as you record it, follow the same instructions as for tape playback. To hear the sound before it is dubbed, turn the TAPE PLAY switch to the circuit (TAPE-1 or TAPE-2) to which the deck in playback mode is connected. To monitor the sound after it is dubbed, turn the switch to the circuit to which the deck in record mode is connected.
- When you turn the TAPE PLAY switch to the SOURCE position during tape-to-tape copying or dubbing, you can enjoy other program sources (records or radio broadcasts) without interrupting the dubbing process.

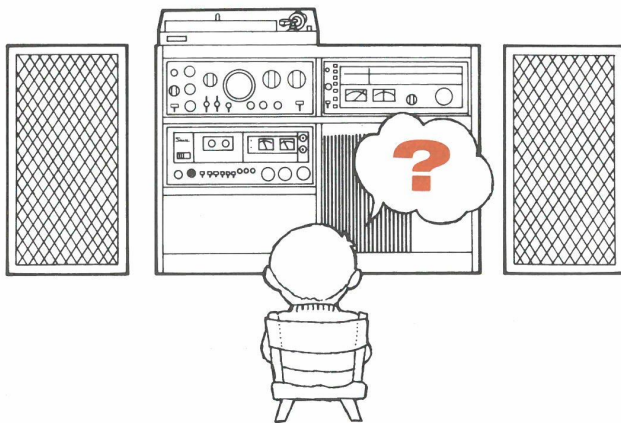

When you hear no sound

Some of the symptoms which seem to indicate a breakdown of the unit are caused by misoperation of the unit or other connected components. Confirm the connections and your operating procedure once more. Be sure to turn the power off or reduce the volume beforehand.

Check list of operation

1. Is the POWER switch turned on?
2. Is the TAPE PLAY switch set to SOURCE when you do not wish to reproduce a tape?
3. Are the INPUT SELECTOR switch and TUNER selector turned to the correct positions?
4. Is the SPEAKERS switch turned to the correct position?
5. Is the PRE-MAIN separate switch set to CONNECTED?

Check list of connections

1. Is the power cord inserted in a wall-AC outlet?
2. Are the connection cords for your turntable and tape deck loose or touching some other object?
3. Are the speaker connection cords loose from the unit or the speakers?

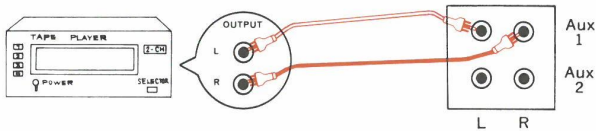
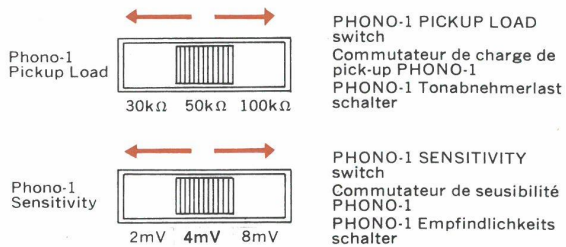

SOME USEFUL HINTS

Changing response according to the cartridge in use

PHONO-1 SENSITIVITY Switch

Set this switch to the position which roughly corresponds to the output voltage (rated) of the cartridge in use or the output voltage of a step-up transformer if one is used. (The rated output voltage of a cartridge is usually listed in its specification chart.) The switch changes the input sensitivity of the PHONO-1 circuit only.

PHONO-1 PICKUP LOAD Switch

With the PHONO-1 circuit, you can change the input resistance (or load resistance of the cartridge in use) from 50 kilo-ohms to 30 kilo-ohms to 100 kilo-ohms. The result you will obtain is a subtle change in level in the high-frequency response. Select the position to best suit the response to your taste.

How to use AUX inputs

"AUX" means auxiliary, and the AUX inputs have the same electrical function as the TAPE PLAY inputs. They therefore connect a tape deck, a CD-4* demodulator, an adaptor for special cartridges, and other equipment that provides about same output level as the afore-mentioned components.

*CD-4 is a trademark of JVC, Inc.

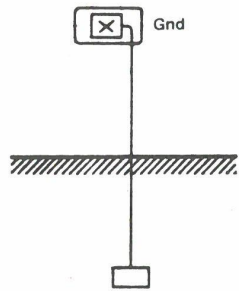
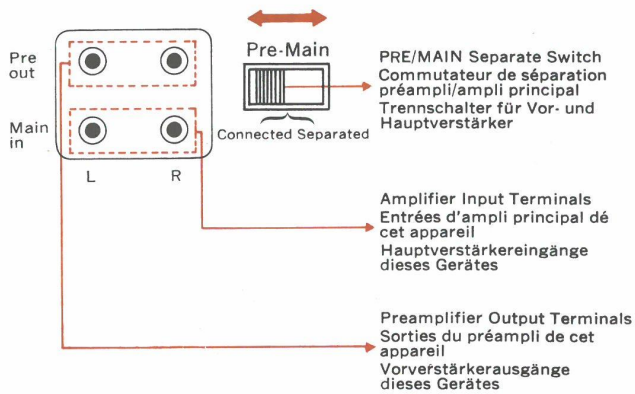

Separation of preamplifier and power amplifier sections

With your unit, you can separate the preamplifier (control) section from the main (power) amplifier section for independent uses; you can connect a separate preamplifier or power amplifier to the unit, or construct a multi-amplifier (electronic crossover) system. To separate these two sections, set the PRE-MAIN separate switch on the left side panel to SEPARATED. Be sure to set the POWER switch to OFF beforehand. Connect the PRE OUT terminals to the input terminals of the separate power amplifier or, in constructing an electronic crossover system, to the input terminals of a channel divider. The MAIN IN terminals should be connected with the output terminals of a separate preamplifier or of a channel divider.

- In an electronic crossover (multi-amplifier) system, the entire audio frequency spectrum is divided into several ranges, and each range is amplified by a separate amplifier and reproduced by a separate speaker unit. This system allows you to improve tonal quality better suited to your taste. Ask your Sansui dealer for further information.

4-Channel system

In a matrix 4-channel system, the 4-channel adaptor should be connected to the TAPE-2 REC/PLAY terminals. You can use the unit's tone control circuits for tonal adjustments of the front channels.

Grounding

Grounding the unit may reduce hum during record playback and noise during AM reception.

Grounding the unit to earth

Connect one end of a vinyl or enameled insulated cord to the GND terminal of the unit and the other end to a copper plate or carbon bar. Then bury the plate or bar deep under the ground. The other end of the cord may be connected to a metallic water pipe. NEVER connect it to gas pipe, since it is dangerous. Earth grounding of the unit is unnecessary when one of the connected components is already grounded to earth.

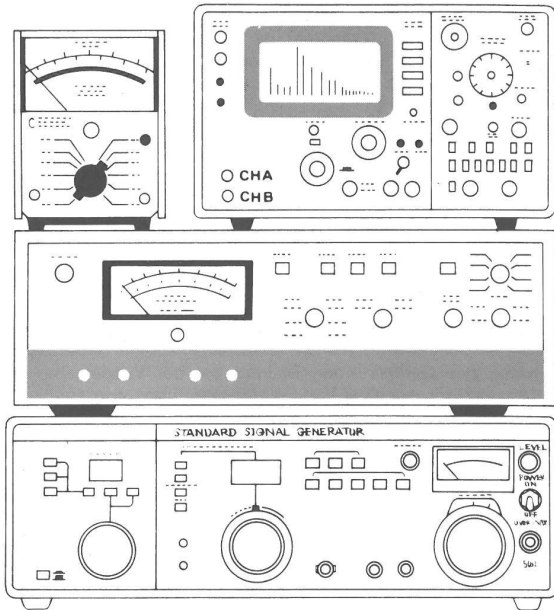

SPECIFICATIONS

Power output

Min. RMS, both channels driven, from 20 to 20,000 Hz, with no more than 0.05% total harmonic distortion

110 watts per channel into 8 ohms

Min. RMS, both channels driven, at 1,000 Hz, with no more than 0.05% total harmonic distortion 110 watts per channel into 8 ohms

110 watts per channel into 8 ohms

Load impedance 8 ohms (SYSTEM-A or B)
8 ohms (SYSTEM A+B)

Power bandwidth 20 to 20,000 Hz at or below rated min. RMS power output and total harmonic distortion

Total harmonic distortion less than 0.05% at or below rated min. RMS power output

Intermodulation distortion (70 Hz : 7 kHz = 4 : 1 SAMPTE method) less than 0.05%

Frequency response (at 1 watt) 5 to 80,000 Hz ± 1.5 dB

Damping factor approximately 70 at 8-ohm load

RIAA curve deviation (PHONO) +0.2dB, -0.2dB (30 Hz to 15 kHz)

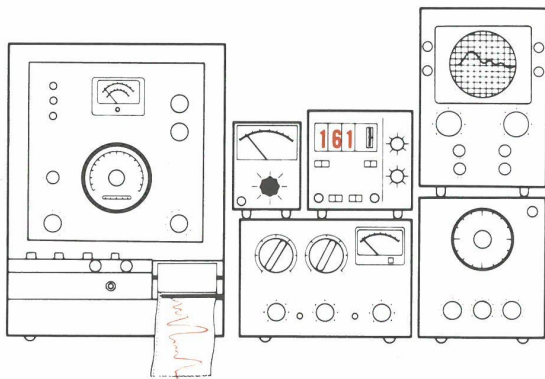

- Input sensitivity and impedance** (1 kHz, for rated power output)
- PHONO-1 2, 4, 8 mV/30, 50, 100 kilohms
(Max. input capability: 1,000 mV at 1 kHz, less than 0.1% total harmonic distortion and PHONO-1 SENSITIVITY switch at 8 mV)
 - PHONO-2 2 mV/50 kilohms
(Max. input capability: 250 mV at 1 kHz, less than 0.1% total harmonic distortion)
 - AUX-1,2 TAPE 150 mV/50 kilohms
- Output level** (1,000 Hz)
- TAPE-1,2 REC (pin jacks) 150 mV/560 ohms
 - TAPE-2 REC/PLAY (DIN socket) 30 mV/70 kilohms
 - PRE OUT 1 V/560 ohms
- Channel separation** (1 kHz, at rated power output)
- PHONO-1,2 better than 60dB
 - AUX-1,2 better than 60dB
- Hum and noise** (short-circuit, A-network)
- PHONO-1 75dB (PHONO-1 SENSITIVITY Switch at 4 mV)
 - AUX-1,2 better than 90 dB
- Controls**
- BASS ±10dB (30 Hz)
Tone selector
(turnover frequency) 150, 300, 600 Hz
 - MIDRANGE ±5dB (1 kHz)
 - TREBLE ±10dB (20 kHz)
Tone selector
(turnover frequency) 2, 4, 8 kHz
 - LOW FILTER -3dB (20, 60 Hz), 12dB/oct.
 - HIGH FILTER -3dB (7 kHz), 6dB/oct.
-3dB (12 kHz), 12dB/oct.
 - MUTING -20dB

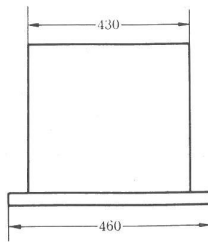
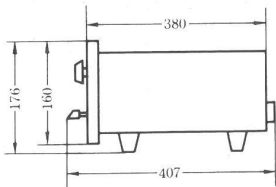

Power requirements

Power voltage 100, 120, 220, 240 V (50/60 Hz)
 120 V (Usable 110-130 V)
 60 Hz (for U.S.A. & Canada only)

Power consumption

Maximum consumption 915 watts
 Rated consumption 480 watts 605 VA

Dimensions

. 460 mm (18 1/8") W
 176 mm (6 15/16") H
 407 mm (16 1/16") D

Weight

. 19.2 kg (42.3 lbs) net
 21.3 kg (47.0 lbs) packed

* Design and specifications subject to change without notice for improvements.

* In order to simplify the explanation illustrations may sometimes differ from the originals.

Sansui

SANSUI ELECTRIC CO., LTD.

14-1 Izumi 2-Chome, Suginami-ku, TOKYO 168, JAPAN
TELEPHONE: (03) 323-1111/TELEX. 232-2076

Printed in Japan (37M2) (9202450)